

TIP PROJECT: HS-2014Z

CONTRACT: DN01056

See Sheet 1A For Index of Sheets
See Sheet 1B For Conventional Plan Sheet Symbols

STATE OF NORTH CAROLINA
DIVISION OF HIGHWAYS

SWAIN COUNTY

LOCATION: *SR 1337 (DEEP CREEK RD).*
NEAR SR 1336

TYPE OF WORK: *SIDEWALK, CURB RAMPS,*
PAVEMENT MARKINGS

STATE	STATE PROJECT REFERENCE NO.	SHEET NO.	TOTAL SHEETS
N.C.	HS-2014Z	1	
STATE PROJ. NO.	F. A. PROJ. NO.	DESCRIPTION	
49336.1.27	4933604	P.E.	
49336.3.27	4933604	CONSTRUCTION	

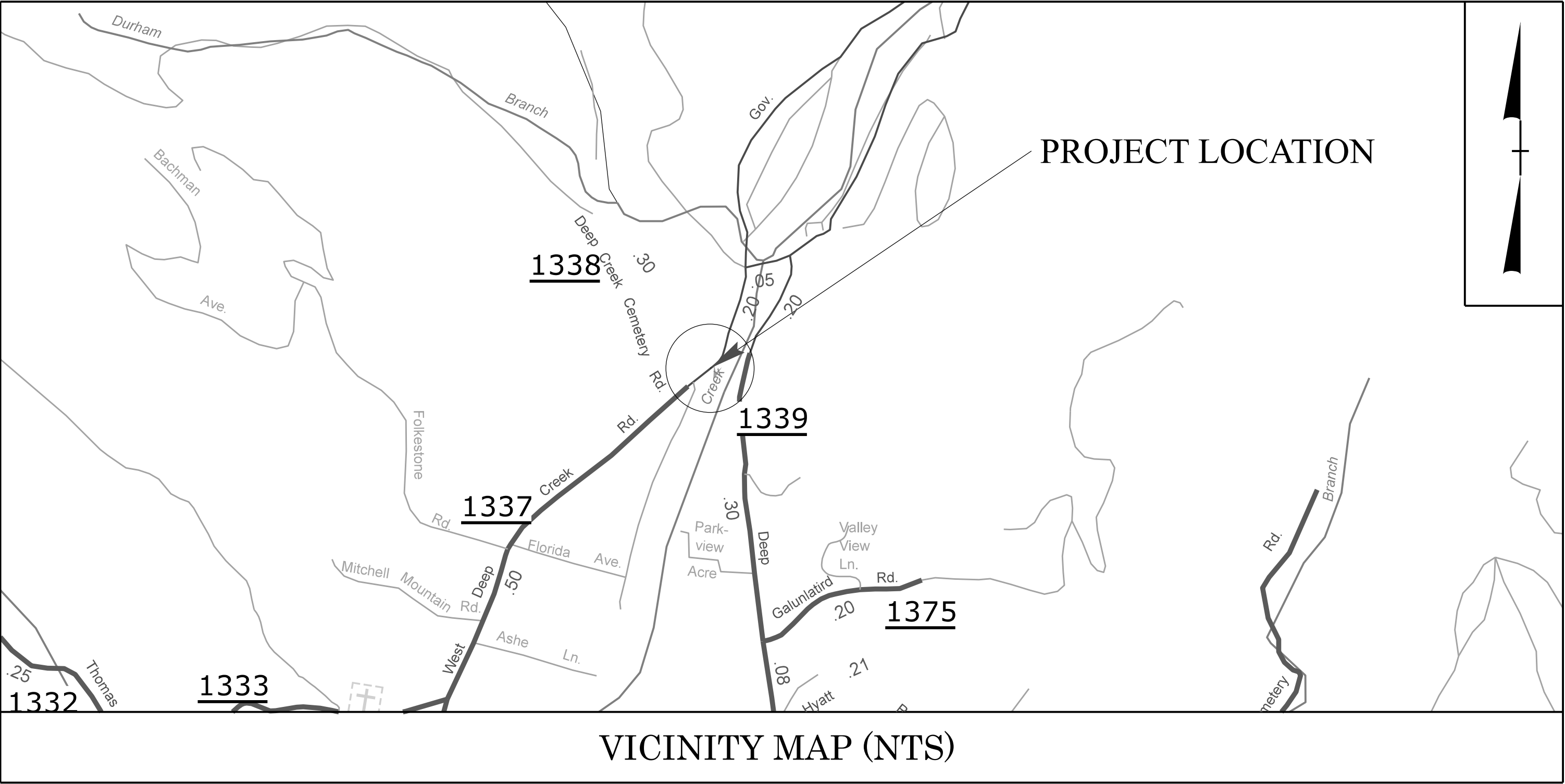

VICINITY MAP (NTS)

DOCUMENT NOT CONSIDERED FINAL
UNLESS ALL SIGNATURES COMPLETED

GRAPHIC SCALES

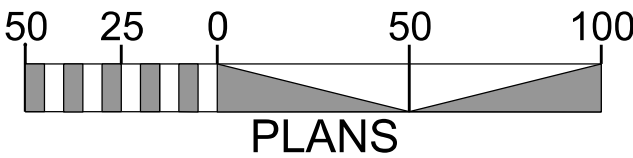

PROJECT LENGTH

TOTAL LENGTH OF TIP PROJECT HS-2014Z = 0.018 MILES

Prepared in the Office of:
DIVISION OF HIGHWAYS
253 Webster Rd., Sylva NC, 28779

2024 STANDARD SPECIFICATIONS

RIGHT OF WAY DATE:
N/A

LETTING DATE:
SEPTEMBER 9, 2025

JAMES HOLLINGSWORTH, PE
PROJECT ENGINEER

JAMES HOLLINGSWORTH, PE
PROJECT DESIGN ENGINEER

HYDRAULICS ENGINEER

7/7/2025

DocuSigned by:
James Hollingsworth
SIGNATURE: P.E.

ROADWAY DESIGN ENGINEER

7/7/2025

DocuSigned by:
James Hollingsworth
SIGNATURE: P.E.

